

Straight Unit

for Manufacturer	
	
for Machine type	
SL 20/30	
Dimensions	
Turret type	Star-type Turret
Shank	VDI 40
Drive	Contrate Toothing

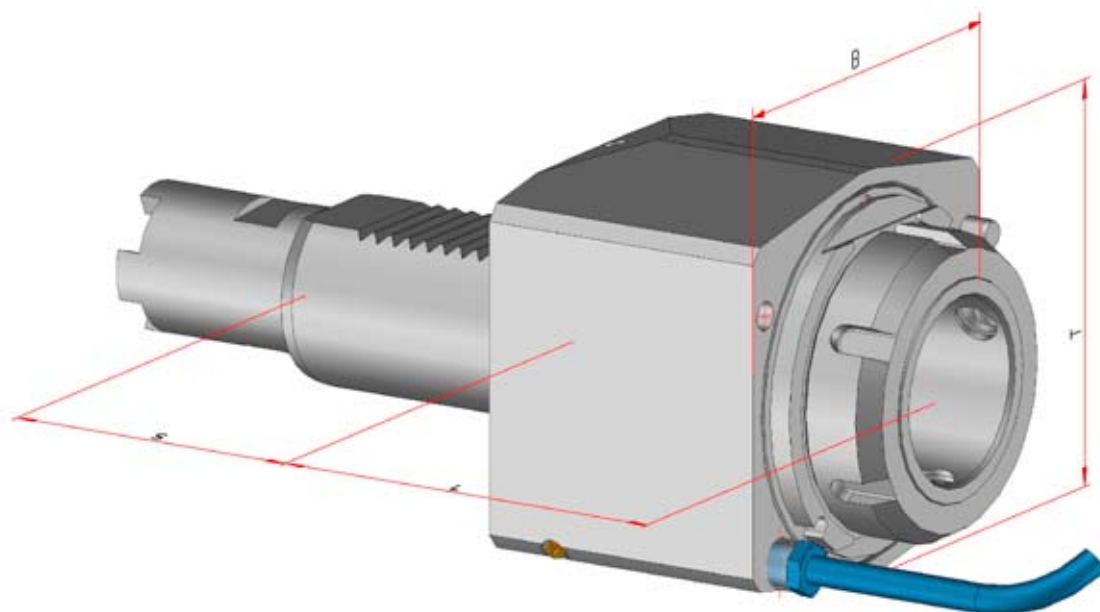

Order No.	Tool holder	Clamping range mm	Torque max.	n1/n2 (max.) (r.p.m.)	Gear Ratio	Coolant	X mm	L mm	B mm	B1 mm	T mm	S mm
100434	ER 32	1-20	80 Nm		i = 1:1	external	-	75,5	85	42	84	104,85
169129	ER 32	1-20	80 Nm		i = 1:1	external	-	75,5	85	42	84	117,55
124231	ER 32	1-20	80 Nm	6.500 / 6.500	i = 1:1	internal	-	75,5	85	42	84	104,85
124232	ER 32	1-20	80 Nm	6.500 / 6.500	i = 1:1	internal	-	75,5	85	42	84	117,55
100833	MI 50	-	80 Nm	6.500 / 6.500	i = 1:1	internal	-	85	85	42	84	104,85
169595	MI 50	-	80 Nm	6.500 / 6.500	i = 1:1	internal	-	85	85	42	84	117,55

Angle Unit

for Manufacturer	
	
for Machine type	
SL 20/30	
Dimensions	
Turret type	Star-type Turret
Shank	VDI 40
Drive	Contrate Tothing
no reversion of rotation	

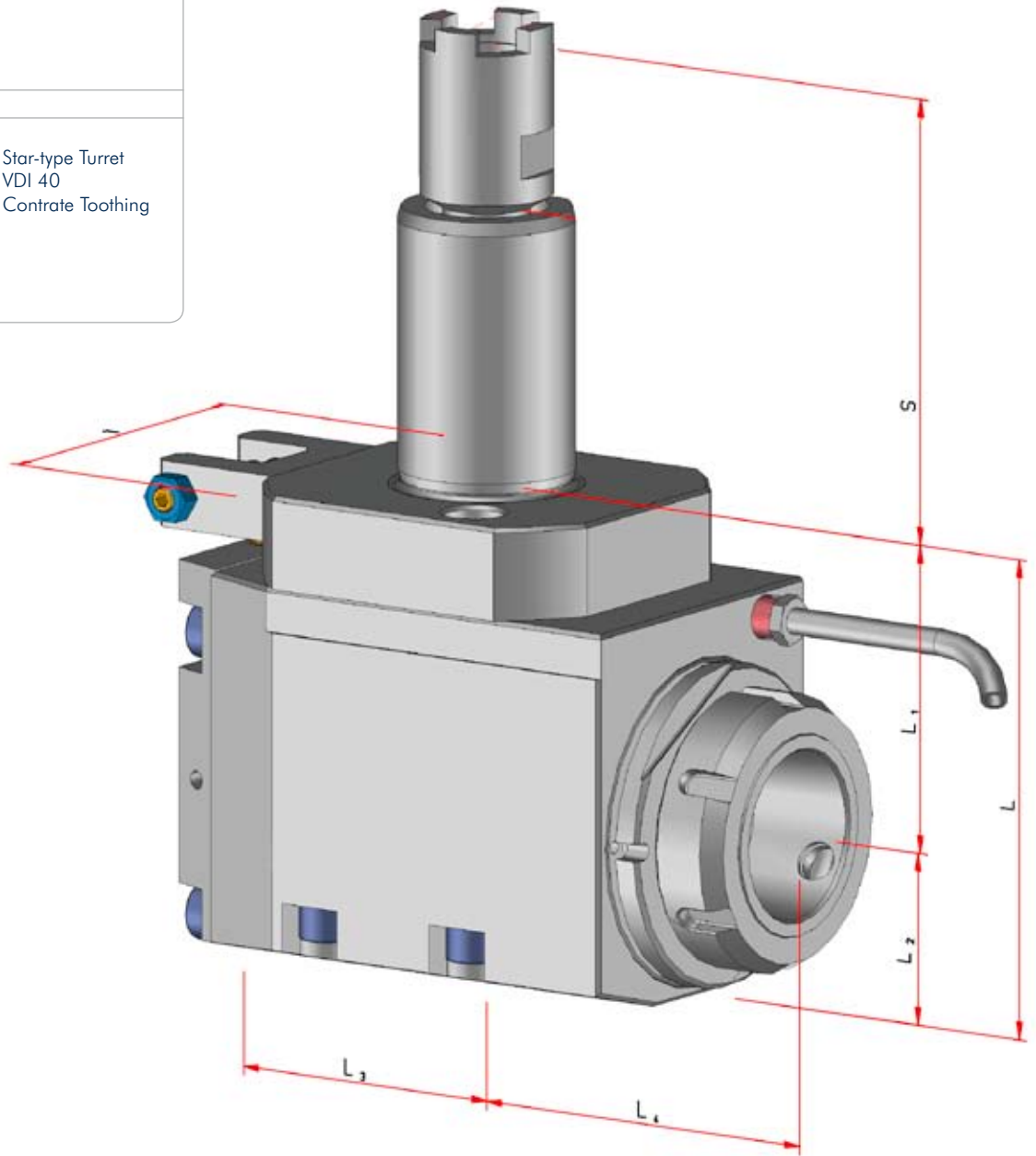

Order No.	Tool holder	Clamping range mm	Torque max.	n1/n2 (max.) (r.p.m.)	Gear Ratio	Coolant	L mm	L1 mm	L2 mm	L3 mm	L4 mm	T mm	S mm
101174	ER 32	1-20	50 Nm	6.500 / 6.500	i = 1:1	external	109	70	39	66	70	80	104,85
169141	ER 32	1-20	50 Nm	6.500 / 6.500	i = 1:1	external	109	70	39	66	70	80	117,55
124836	ER 32	1-20	50 Nm	6.500 / 6.500	i = 1:1	internal	109	70	39	66	70	80	104,85
166691	ER 32	1-20	50 Nm	6.500 / 6.500	i = 1:1	internal	109	70	39	66	70	80	117,55
101477	MI 50	-	50 Nm	6.500 / 6.500	i = 1:1	internal	109	70	39	66	85	80	104,85
169593	MI 50	.	50 Nm	6.500 / 6.500	i = 1:1	internal	109	70	39	66	85	80	117,55