

LOKUMA LB 300 - M/MY / LU 300 - M/MY

Data

Machine type Series		Turret Stations
LB 300	M / MY	12
LU 300	M / MY	12



Disc-type Turret VDI 40

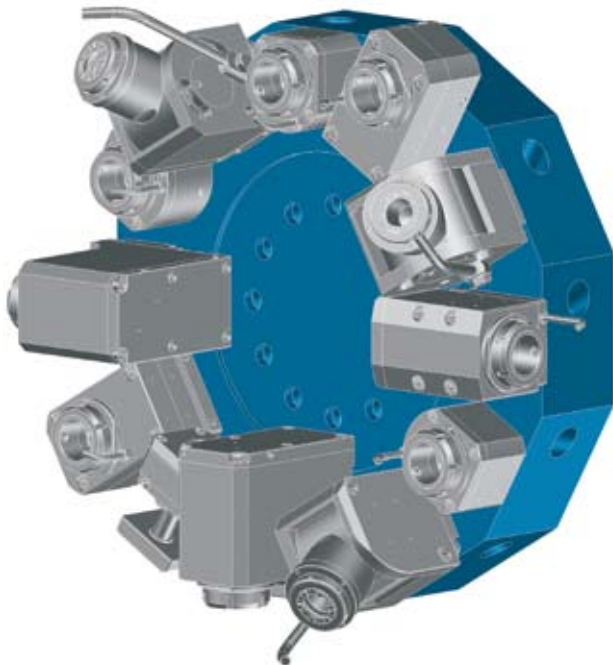

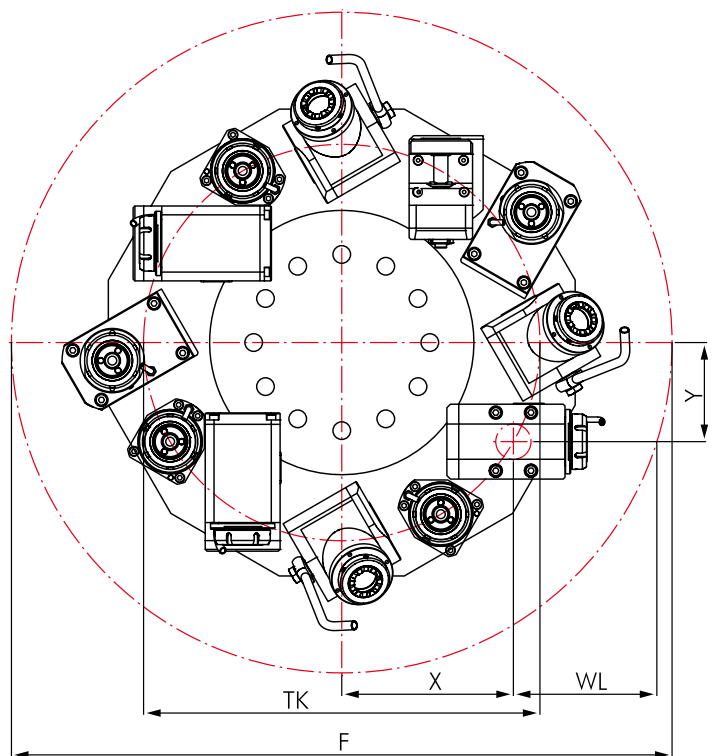

Interference Circles



Machine type Series	F	TK	X	Y	WL
LB/LU 300 M	690	386	185	55	155
LB/LU 300 MY	700	448	175	140	145

Driven Toolholders

	Page		Page
Straight Unit			162
Angle Unit			163

Options and Accessories

mi Toolholders		mi System Description Toolholders Accessories	275 278-283 283-284
Standard VDI Toolholders		VDI Toolholders Accessories	301-308 309-310
Accessories		Collets DIN 6499 Threading Collets Wrenches Clamping Nuts Sleeves and Bushings	309 309 309 309 310



Straight Unit

for Manufacturer	
LOKUMA	
for Machine type	
LB 300 - M / MY LU 300 - M / MY	
Dimensions	
Revolver type	Disc-type Turret
Shank	VDI 40
Drive	single level
Graduation	30 / 60°

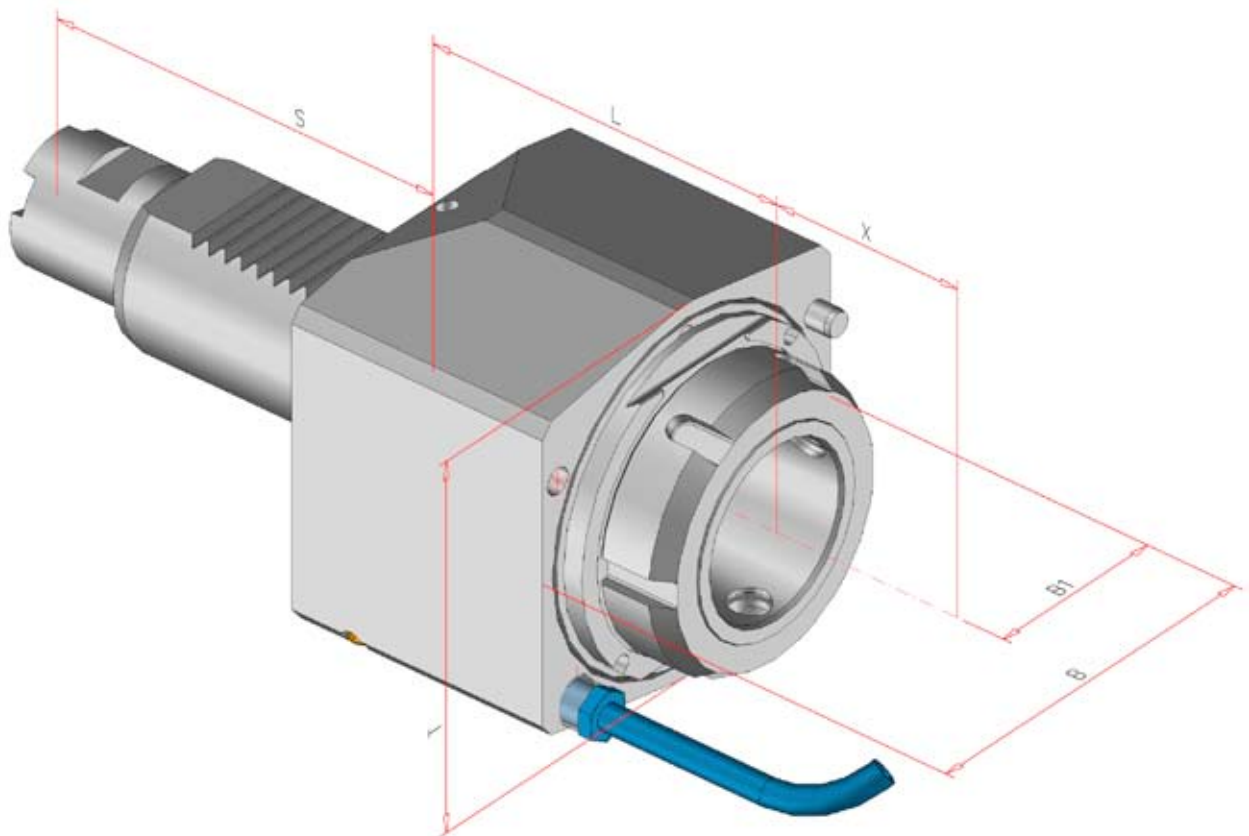

Order No.	Tool holder	Clamping range mm	Torque max.	n1/n2 (max.) (r.p.m.)	Gear Ratio	Coolant	X mm	L mm	B mm	B1 mm	S mm	T mm
103441	ER 32	1,0-20	80 Nm	6.500 / 6.500	i = 1:1	external	-	75,5	87	38	93	75
133711	ER 32	1,0-20	80 Nm	6.500 / 6.500	i = 1:1	internal	-	75,5	87	38	93	75
133712	mi 50		80 Nm	6.500 / 6.500	i = 1:1	internal	-	85,0	84	42	93	84

Angle Unit

for Manufacturer

LOKUMA

for Machine type

LB 300 - M / MY
LU 300 - M / MY

Dimensions

Revolver type	Disc-type Turret
Shank	VDI 40
Drive	single level
Graduation	30 / 60°
Note	no reversion of rotation (drive side direction = output side direction)

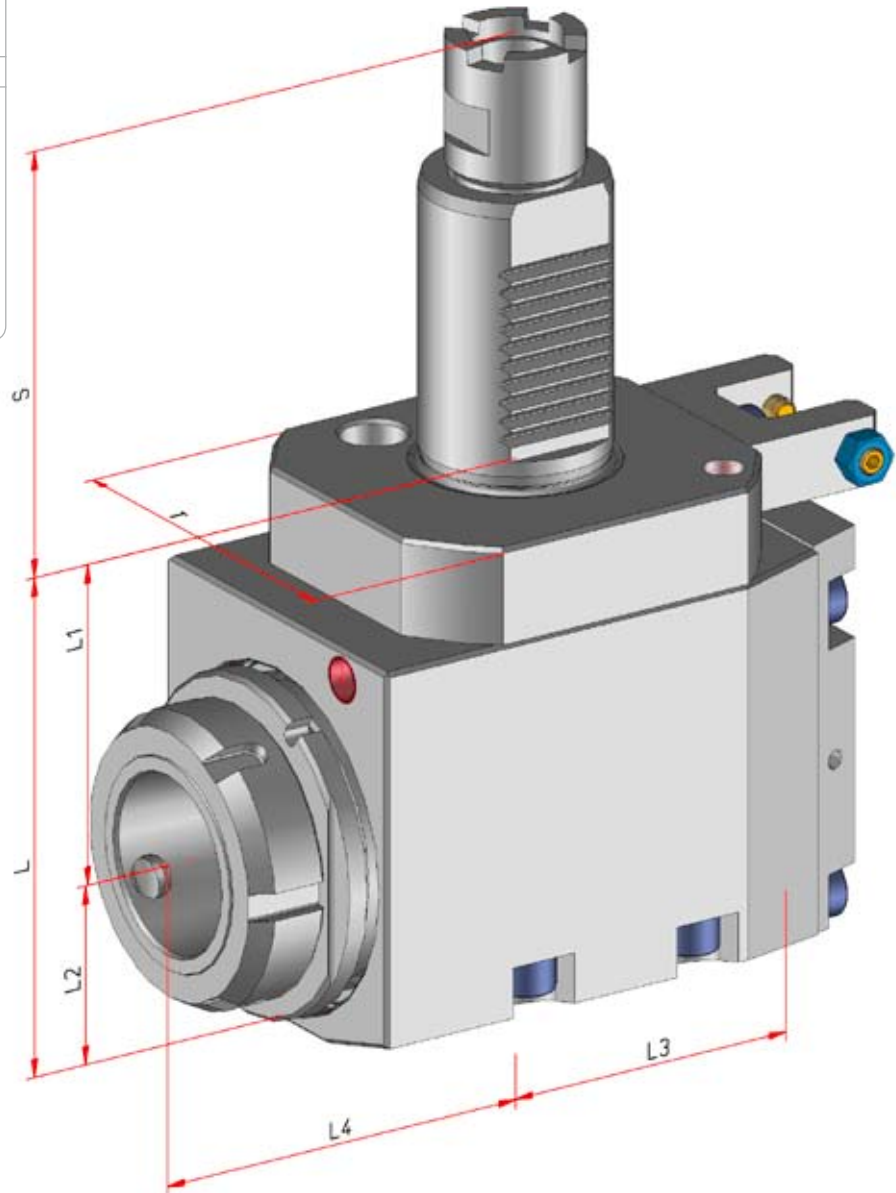

Order No.	Tool holder	Clamping range mm	Torque max.	n1/n2 (max.) (r.p.m.)	Gear Ratio	Coolant	L mm	L1 mm	L2 mm	L3 mm	L4 mm	S mm	T mm
103497	ER 32	1,0-20	50 Nm	6.500 / 6.500	i = 1:1	external	109	70	39	66	70	93	80
133716	ER 32	1,0-20	50 Nm	6.500 / 6.500	i = 1:1	internal	109	70	39	66	70	93	80
133705	mi 50		50 Nm	6.500 / 6.500	i = 1:1	internal	109	70	39	66	85	93	80

