

LOKUMA LB 300 - MW/MYW + LT 300 - M/MY

Data

Machine type Series		Turret Stations
LB 300	MW / MYW	12
LT 300	M / MY	12



Star-type Turret VDI 40

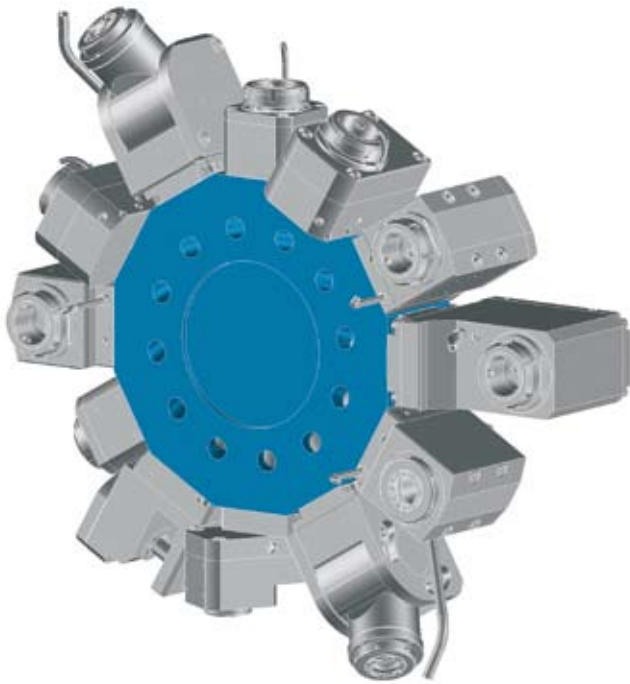

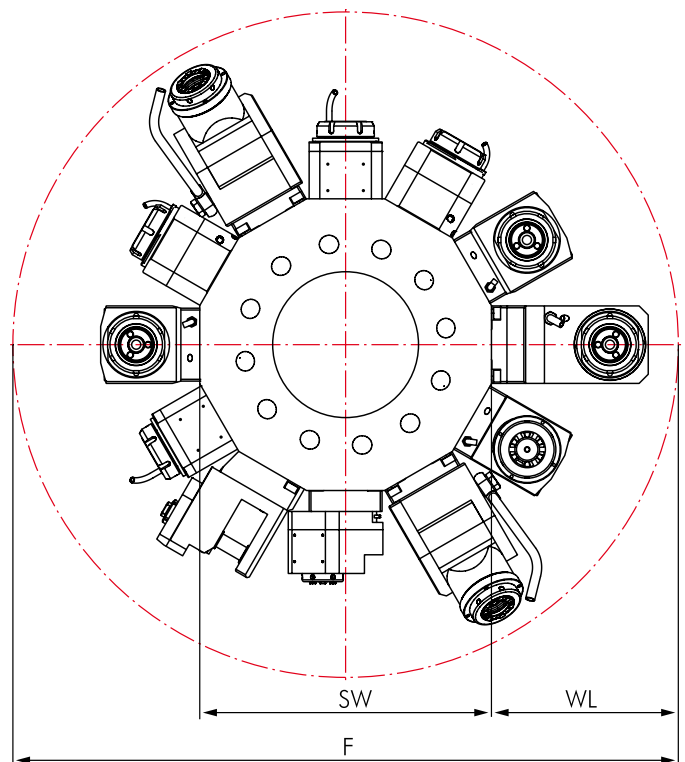

Interference Circles



Machine type Series	F	SW	WL
LB 300 MW/MYW	610	340	135
LT 300 M/MY	650	380	135

Driven Toolholders

	Page		Page
Straight Unit			166
Angle Unit			167-168

Options and Accessories

mi Toolholders		mi System Description Toolholders Accessories	275 278-283 283-284
Accessories		Collets DIN 6499 Threading Collets Wrenches Clamping Nuts Sleeves and Bushings	309 309 309 309 310



Straight Unit

for Manufacturer	
LOKUMA	
for Machine type	
LB 300 - MW / MYW LT 300 - M / MY	
Dimensions	
Revolver type	Star-type Turret
Shank	VDI 40
Drive	Layer gear; single level
Graduation	30 / 60°

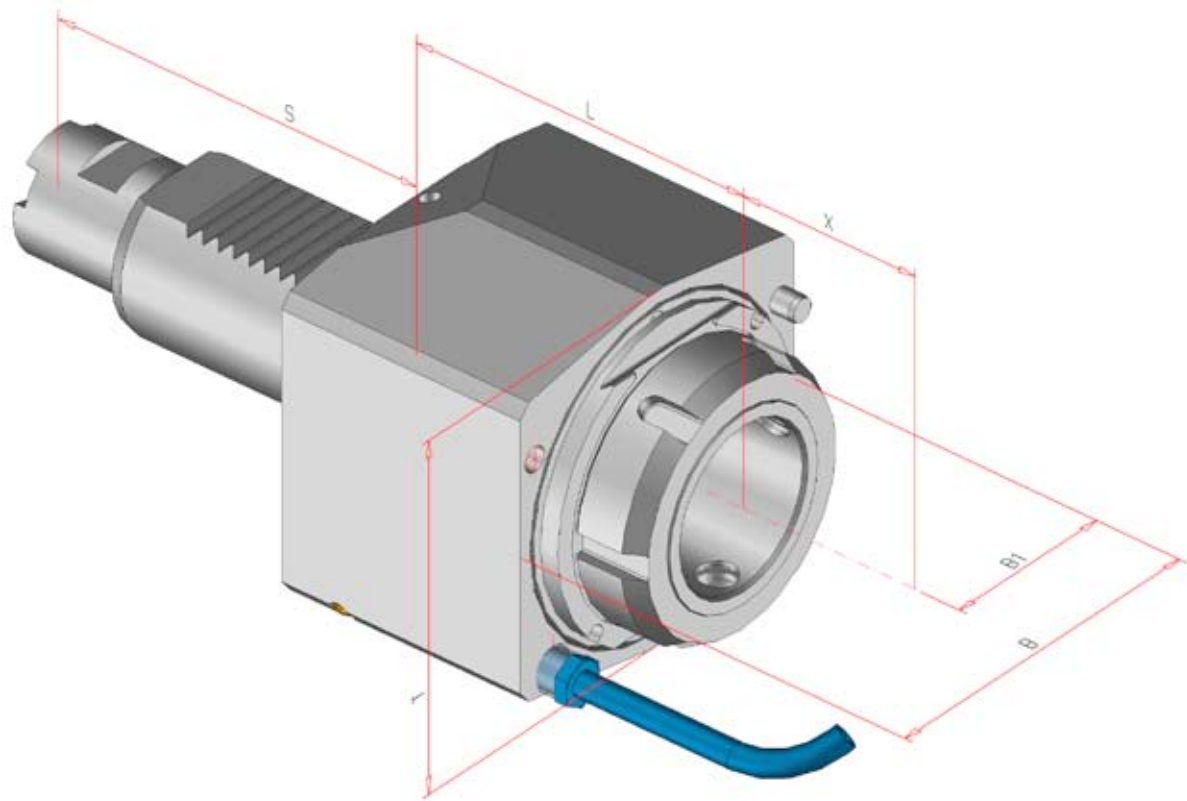

Order No.	Tool holder	Clamping range mm	Torque max.	n1/n2 (max.) (r.p.m.)	Gear Ratio	Coolant	X mm	L mm	B mm	B1 mm	S mm	T mm
103441	ER 32	1,0-20	80 Nm	6.500 / 6.500	i = 1:1	external	59,5	75,5	87	38	93	75
133711	ER 32	1,0-20	80 Nm	6.500 / 6.500	i = 1:1	internal	59,5	75,5	87	38	93	75
133712	mi 50		80 Nm	6.500 / 6.500	i = 1:1	internal	50,0	85,0	84	42	93	84

Angle Unit, Left-hand Version for Main-Spindle

for Manufacturer



for Machine type

LB 300 - MW / MYW
LT 300 - M / MY

Dimensions

Revolver type	Star-type Turret
Shank	VDI 40
Drive	Layer gear; single level
Graduation	30 / 60°
Note	no reversion of rotation (drive side direction = output side direction)

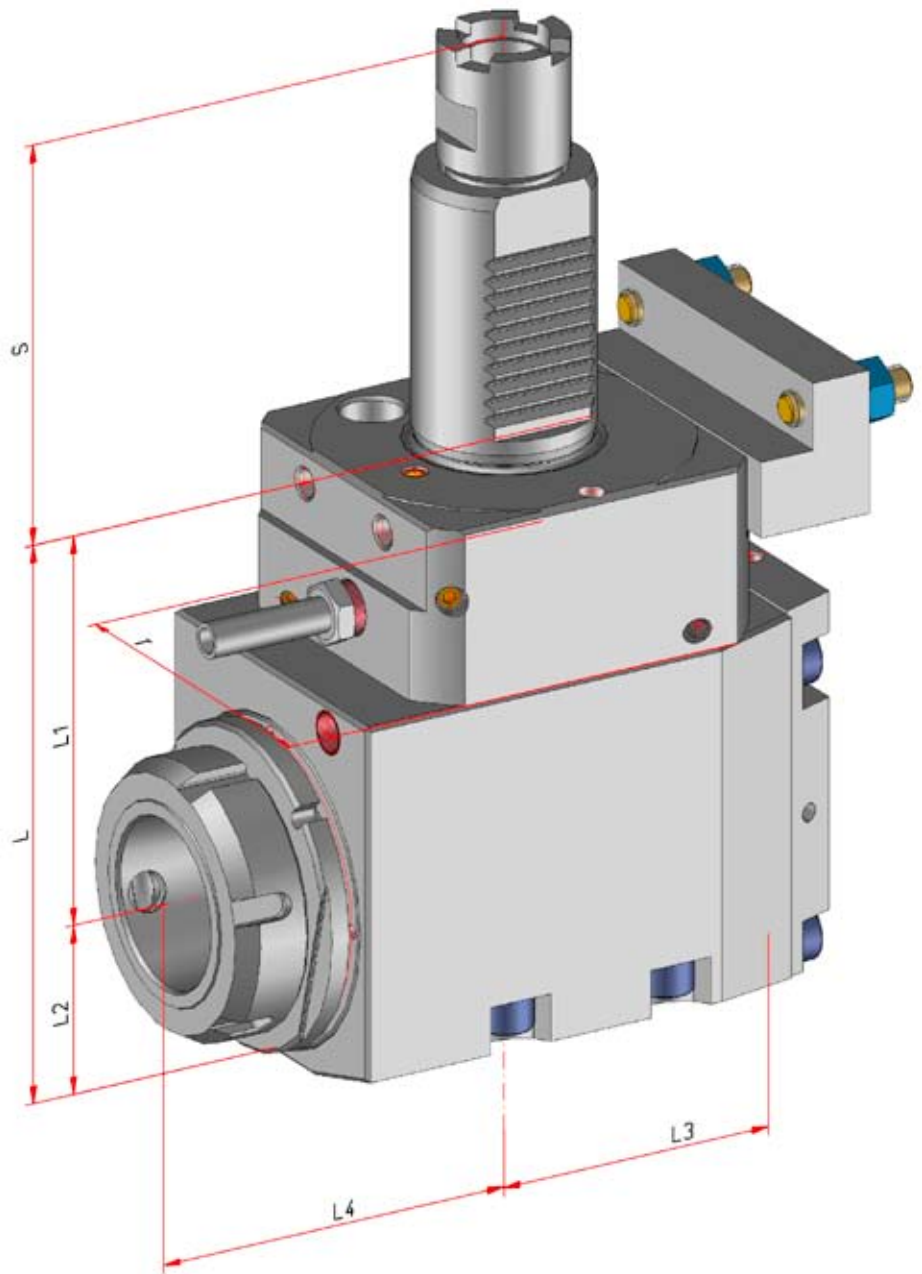

Order No.	Tool holder	Clamping range mm	Torque max.	n1/n2 (max.) (r.p.m.)	Gear Ratio	Coolant	L mm	L1 mm	L2 mm	L3 mm	L4 mm	S mm	T mm
133704	ER 32	1,0-20	50 Nm	6.500 / 6.500	i = 1:1	external	129	90	39	66	70	93	80
103478	ER 32	1,0-20	50 Nm	6.500 / 6.500	i = 1:1	internal	129	90	39	66	70	93	80
103462	mi 50		50 Nm	6.500 / 6.500	i = 1:1	internal	129	90	39	66	85	93	80
133818*	mi 40		25 Nm	6.500 / 13.000	i = 1:2		129	90	39	72,5	92	93	85

* Reversion of rotation

Angle Unit, Right-hand Version for Sub-Spindle

for Manufacturer



for Machine type

LB 300 - MW / MYW
LT 300 - M / MY

Dimensions

Revolver type	Star-type Turret
Shank	VDI 40
Drive	Layer gear; single level
Graduation	30 / 60°
Note	no reversion of rotation (drive side direction = output side direction)

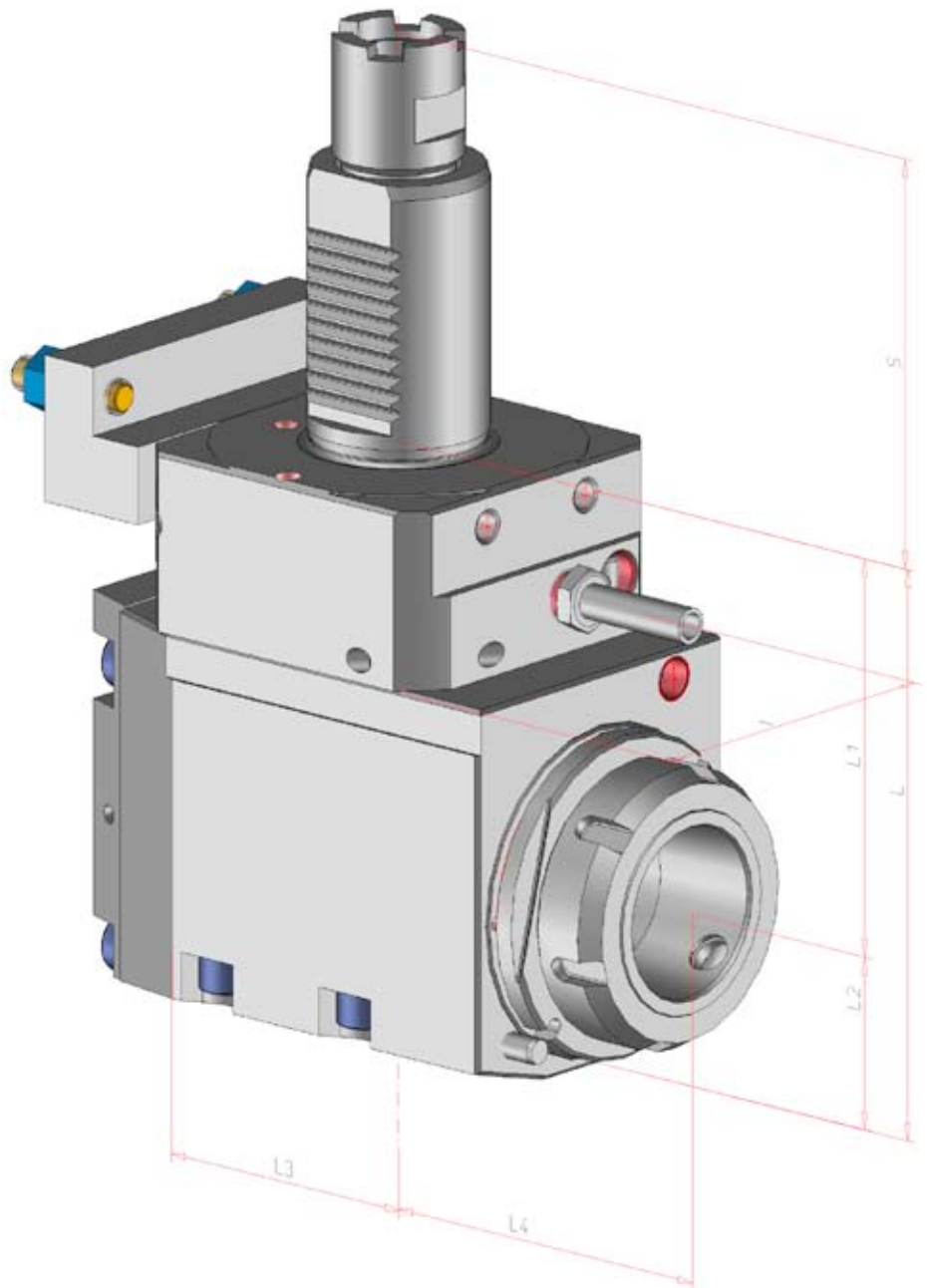

Order No.	Tool holder	Clamping range mm	Torque max.	n1/n2 (max.) (r.p.m.)	Gear Ratio	Coolant	L mm	L1 mm	L2 mm	L3 mm	L4 mm	S mm	T mm
103471	ER 32	1,0-20	50 Nm	6.500 / 6.500	i = 1:1	external	129	90	39	66	70	93	80
124845	ER 32	1,0-20	50 Nm	6.500 / 6.500	i = 1:1	internal	129	90	39	66	70	93	80
103523	mi 50		50 Nm	6.500 / 6.500	i = 1:1	internal	129	90	39	66	85	93	80